

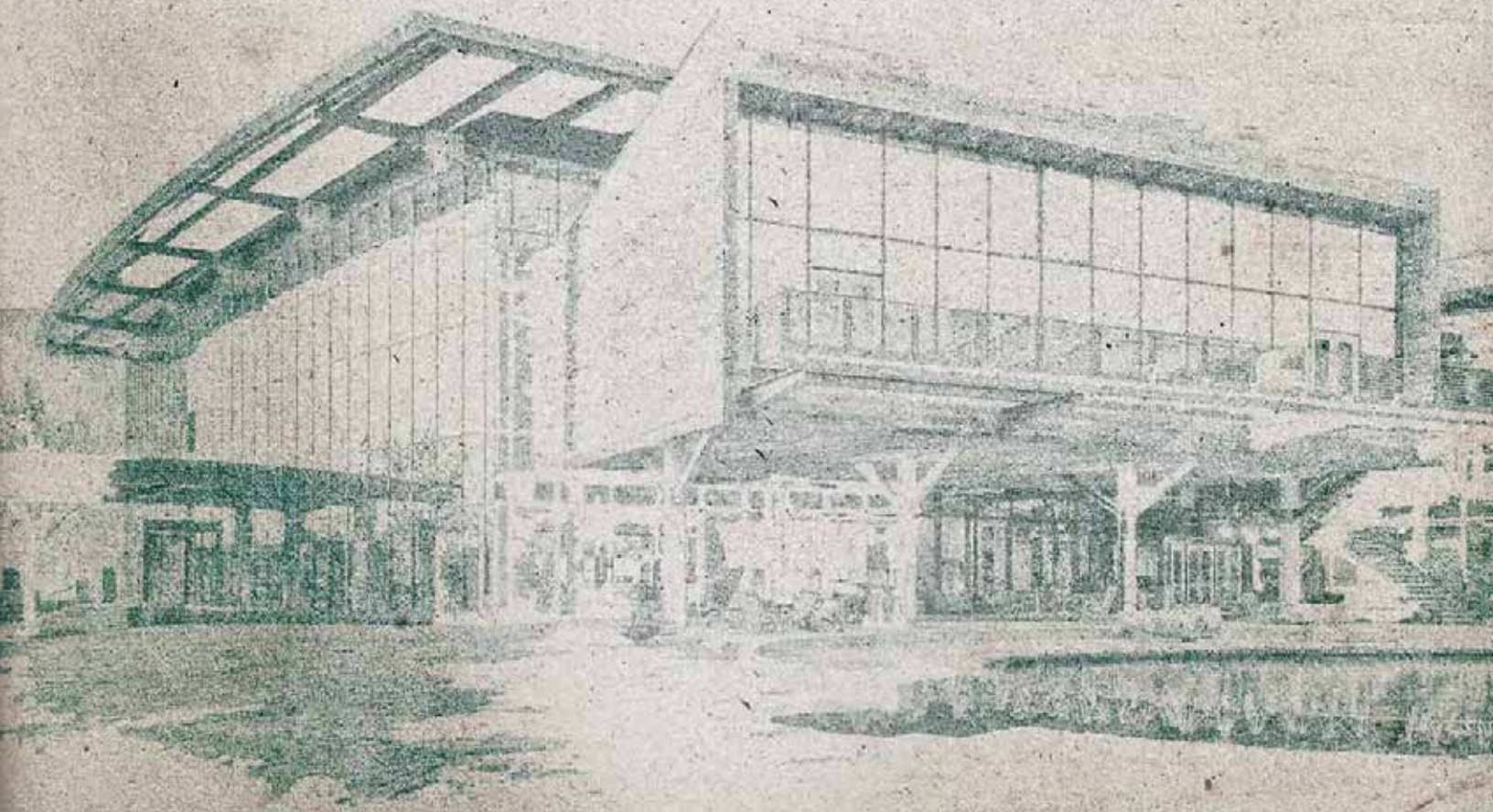

WATERMARK  
COMMUNITY CHURCH



# About the Facilities...

Watermark Community Church purchased a nine-story, 140,000 SF office building at the intersection of two major thoroughfares in North Dallas in 2004 and began renovating one floor at a time. Rather than letting the corporate structure of the building define the church, they imprinted their culture in the furnishings, artwork and signage. The finishes are natural—what Senior Director of Arts, Gary Stroope describes as “an REI vibe.” Warm colors, clean lines and natural materials create a signature aesthetic. The church and design team worked together closely to retrofit the structure which today provides accommodations for administrative offices, children’s ministry and various adult ministries.

The campus was built on cash as funds were available and was implemented in phases. In September 2007, a 2100-seat worship center, was constructed and connected by a skybridge. The interim worship center—which served the church for 4 years—was built inside a rectangular building and was always intended to be dismantled and renovated into the children’s building. The Children’s building design is underway and construction is planned for the near future. Completion of the Children’s building will fulfill the masterplan goals for this campus.

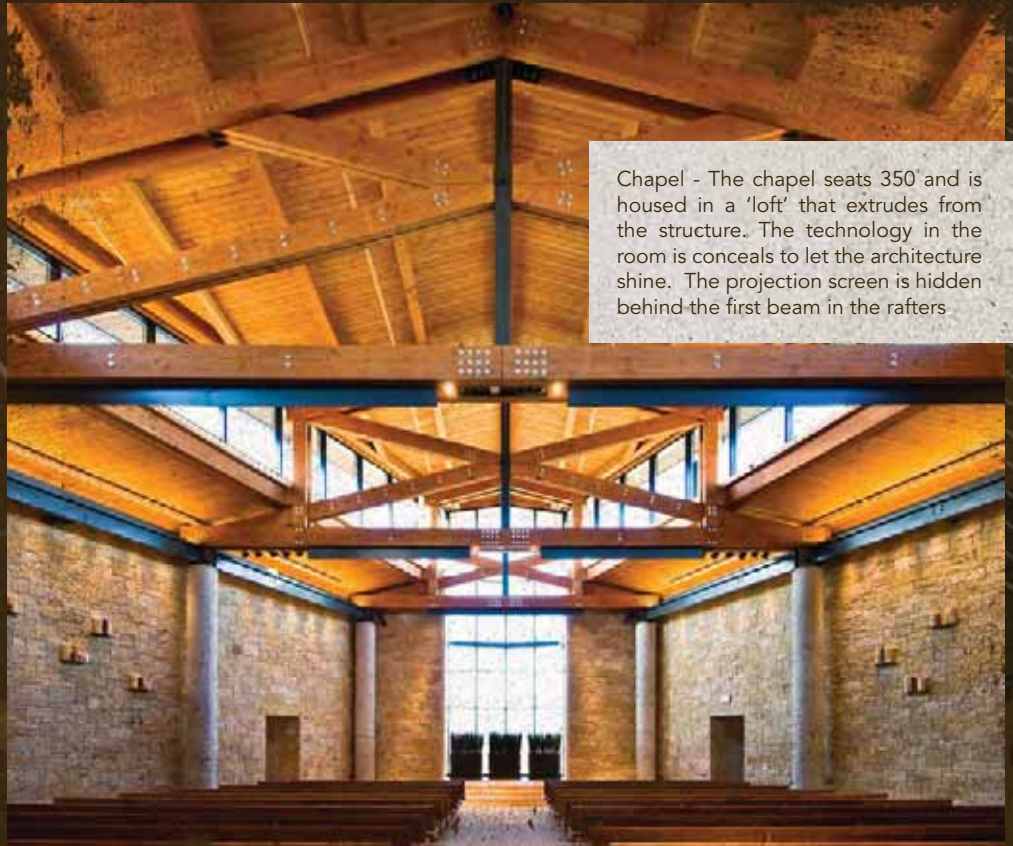

Chapel - The chapel seats 350 and is housed in a 'loft' that extrudes from the structure. The technology in the room is concealed to let the architecture shine. The projection screen is hidden behind the first beam in the rafters.



Video Production Facility - Video is an important communication and environment creation tool for Watermark. The video control room was designed to be simple yet powerful. A second switcher gives them the capacity to cut a separate show for webcast or stretch content across multiple screens.

Town Center - The campus is designed around a common area called the "town center." The flexible space can be 'staged' for events and is available during the week for groups to meet and connect.



## THE TEAM

Watermark Community Church  
Leadership, Vision and Oversight

OMNIPLAN  
Architectural Design & Master-  
planning

Acoustic Dimensions  
Auditorium Consulting, Acoustics,  
Audio, Video, & Lighting Design

Clair Brothers  
Audio, Video, & Lighting Installa-  
tion

Blum Consulting Engineers  
MEP Design

L.A. Fuess Partners, Inc.  
Structural Engineering

Rogers-O'Brien Construction  
Contractor

Church Worx / AnchorPointe  
Owners Representation

The design of the 3,500-seat worship center was driven in large part by the success of the interim worship facility. While it was always intended that the interim space would be dismantled and equipment reused, there was significant reuse of design elements so that the new facility would function in the same manner but with the addition of 1,000 seats. The rake of the upper balcony is designed not only for sightlines to the stage but also to provide views to other worshippers in the auditorium. The catwalks flanking the auditorium add to the sense of a connected experience.

Great care was taken with the seating layout to ensure excellent sightlines. The theatre seating isn't divided with armrests so that the room feels more connected. The auditorium also occupies a fairly tight footprint because of the layout.

The seats are different colors to make the room scalable. When used for smaller events, the upper balconies feel occupied because of the color variance. It also made it easier to relocate the seats from the interim sanctuary to the permanent one.

Five-hundred sheets of birch and OSB plywood were suspended from the ceiling for acoustics and aesthetics. They are topped with absorptive material to provide additional acoustic control.

The stage area is designed to support full production with a green room and set shop on the first floor; the second floor contains a studio and audio/video production suite and the third floor provides storage and access to catwalks. There is also a "tech mezzanine"—an elevated level which supports the IMAG projectors, can be used for additional lighting positions and allows for a secondary entrance to the stage.

There are motorized trusses for lighting and backdrops and a large cyc hangs across the back of the stage to allow for environmental projection. The large side walls—painted white—are used as video canvases.

There is WiFi throughout the facility and auditoriums have video tie lines to support bi-directional connectivity so that they can be used for overflow.

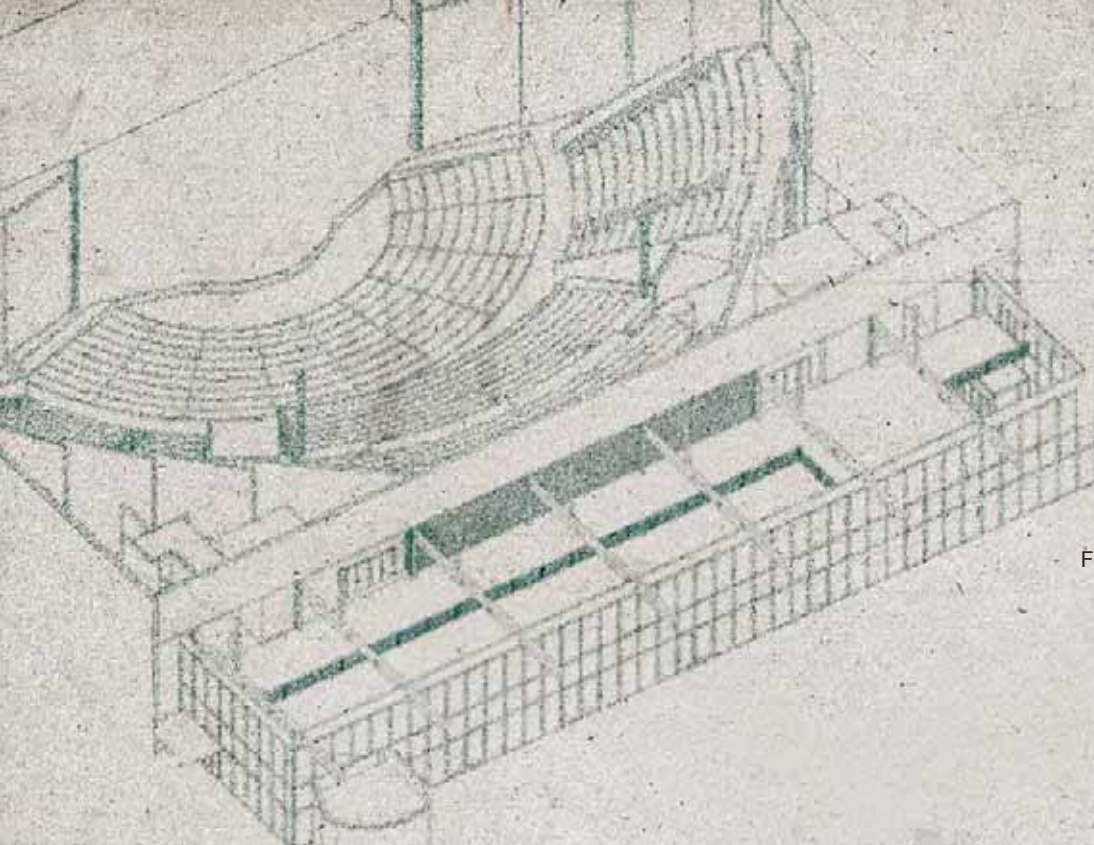

Senior Pastor: Todd Wagner  
 Senior Director: Gary Stroope  
 Attendance: 4,200 adults  
 Members: 3,500 adults  
 9:00 Service: 1,400 adults  
 11:00 Service: 2,500 adults  
 5:30 Service: 1,000 adults

Interim Auditorium: 2,100 seats  
 Current Auditorium: 3,500 seats  
 Multi-Purpose Room: 400 seats  
 Chapel: 300 seats  
 Four Community Rooms: 150 seats ea

Acreege: 11.5 acres  
 Phase I SF: 102,600 sf  
 Phase II SF: 68,000 sf  
 Phase IIIA SF: 129,329 sf  
 Phase IIIB SF: 88,180 sf

## Equipment lists

### Main Loudspeaker Systems

L'Acoustics Kudo Line Arrays  
 L'Acoustics SB28 Subwoofers  
 L'Acoustics Kiva Line Arrays  
 L'Acoustics LA8 Amp/Controllers  
 L'Acoustics 12xt Loudspeakers  
 JBL ASB6128V Subwoofers  
 EAW UB82e Speakers  
 BSS BLU-800 DSP  
 Middle Atlantic Equipment Racks

### Control Booth

Digidesign D-Show Main &  
 D-Show Sidecar  
 TC M-One and D-Two  
 Tascam CD RW991  
 Tascam CD-160  
 JBL LSR4328P  
 Shure UHFR wireless mics  
 Audio Accessories Patchbays  
 Listen Tech LA-80 ALS

### Platform Monitoring

Digidesign SC48  
 Shure PSM900 In Ear Monitors  
 Clair Brothers Wedges  
 Aviom personal monitoring  
 QSC Amplifiers

### Audio Production

Digidesign SC48  
 JBL LSR4328P  
 ProTools HD System

### Cameras

Grass Valley 8926 Series Cameras  
 Canon HJ17x7.7BIRSP,Lenses  
 Carloni Gamma Tripods  
 Sony HDCP1 Box Camera  
 Telemetrics Robotic Control

### Projection

Barco FLM HD20 IMAG Projectors  
 DaLite 300 Series IMAG Screens  
 Barco FLM HD20 Center Projection  
 Gerriets Center Cyc  
 Christie Roadster HD12k - Side  
 Scenic Projection  
 Display Devices Projector Lifts

### Distributed Video

Sharp LCD Displays  
 Blonder Tongue RF Modulators

### Video Production

Grass Valley Kayak HD Switcher  
 Grass Valley Kaleido  
 Barco FSN 1400 switcher  
 Green Hippo Hippotizer Server  
 ADC Triax Patching  
 AJA Conversion and Fiber Gear  
 Black Magic Decklink Extreme  
 Cobalt Video Conversion Gear  
 Ross Video Conversion and  
 Distribution  
 Sony FWDS47H1 Monitors  
 Canare Video Patchbays  
 Clearcom Intercom Systems  
 Leader Test Signal Generator  
 Rane Audio Distribution and  
 Delays  
 Fostex RM-2 Rackmounted  
 Monitor Speaker  
 Extron Video Conversion and  
 Transmission  
 Flanders Engineering Monitors  
 Forecast Video Production  
 Furniture  
 Middle Atlantic Equipment Racks  
 AMX Control Systems

### Dimming

ETC Sensor Racks  
 ETC D20 Modules  
 ETC Unison Entry Stations  
 ETC Distribution Raceway  
 ETC Smartswitch Relay Switches  
 MA Lighting GrandMA Console

### Lighting Fixtures

ETC Source 4 Ellipsoidal  
 ETC Source 4 Par  
 Varilite VL1100 Motorized  
 Lighting Fixtures  
 Varilite VL3000 Motorized  
 Lighting Fixtures  
 Wybron Color Scrollers  
 Lemaitre M.V.S. Hazer  
 Gam Gel  
 Roscolux Gel

### Platform Rigging & Soft Goods

Gerriets Box Truss and Motor  
 Upstage Curtain  
 Gerriets Curtain Track  
 Gerriets Curtains and Borders  
 JR Clancy Lineshafts  
 JR Clancy Motor Control System  
 JTE Box Truss

WATERMARK  
 COMMUNITY CHURCH